



Features of the power supply unit:

- power output 3A/12VDC
- universal AC input voltage range 90÷264V
- high efficiency 83%
- standby power <0,3W
- efficiency level: V
- IP 67 case
- protections:
 - SCP short-circuit protection
 - overvoltage protection (AC input)
 - overload (OLP)
- warranty – 2 year from the production date

1. Technical description.

1.1. General description.

Stabilized DC power supply is intended for supply equipments that require stabilised voltage of **12 V DC**. When connected to fuse blocks of the LB4/xx/xx or LB8/xx/xx family, the power supply unit can feed more equipments (max. 4 or 8). The power supply unit is protected against short-circuit, overload and overvoltage.

1.2. Specifications.

Supply voltage	90 ÷ 264 V AC 50÷60Hz
Current consumption	0,37A@230VAC max.
Supply power	36W max.
Efficiency	83%
Output voltage	12V DC
Output current	3 A
Output current $t_{AMB}<30^{\circ}C$	3 A - refer to graph 1.
Output current $t_{AMB}=40^{\circ}C$	2,1 A - refer to graph 1.
Ripple voltage	100mV p-p max.
Short-circuit protection SCP	electronic, automatic recovery
Overload protection OLP	150-200% of power supply, automatic recovery
IP protection class	IP67
Operation conditions	temperature $-10^{\circ}C\div 40^{\circ}C$ relative humidity 20%...90% without condensation
Dimensions (LxWxH)	135 x 50 x33 [mm]
Net/gross weight	0,31kg / 0,34kg
Protection class PN-EN 60950-1:2007	II (second)
Length of DC cable	0,3 m
Length of AC cable	0,3 m
Storage temperature	$-20^{\circ}C...+60^{\circ}C$

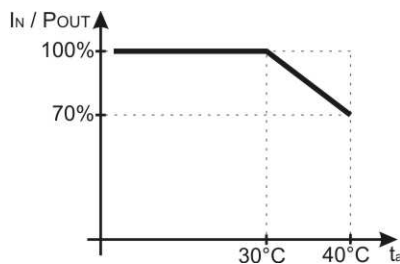

Graph 1.
 Relation between output current and ambient temperature.

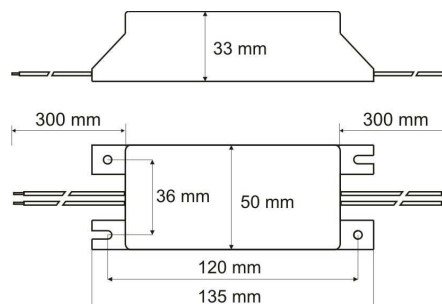

Fig.1. Dimensions of power supply.

1.3. Accessories.

For the power supplies are available accessories - fuse blocks and cable adapter. For details –visit www.pulsar.pl

2. Installation.

2.1. Requirements.

The power supply shall be mounted by the qualified installer having appropriate (required and necessary for a given country) permissions and qualifications for connecting (operating) low-voltage installations. The power supply shall be mounted in closed rooms, according to the environment class II, of the normal air humidity (RH=90% max.) and the temperature within the range from -10°C to +40°C.

In order to fulfill LVD and EMC requirements the rules for power supplies, encasing and shielding shall be observed according to application.

2.2. Installation procedure.

1. Connect the DC output to the load/loads.
2. Connect the power supply to the AC line. The power supply has to be installed in such way to keep the air flow around the supply unit.
3. After tests and operation control are performed, the casing (cubicle) shall be closed etc.

3. Maintenance.

Any and all maintenance operations may be performed following the disconnection of the power supply from the power network. The power supply does not require any specific maintenance procedures, however, in the case of significant level of dust, it should be cleaned with the compressed air.



WEEE designation

The waste electric and electronic equipment worn out may not be disposed of together with standard household waste. According to the WEEE directive, applicable in the EU, the separate neutralization methods should be used for electric and electronic equipment.

THE GENERAL WARRANTY CONDITIONS

1. Pulsar K. Bogusz, Particular Partnership (the manufacturer) provides a two-year quality warranty for devices, counted from the device's production date.
2. The warranty includes free repair or replace for a functional equivalent (the selection is performed by the manufacturer) of a non-operational device due to reasons dependent on the manufacturer, including production and material defects, as far as defects are notified within the warranty period (item 1 and 2).
3. The equipment subject to warranty shall be provided to the point, where it has been purchased or directly to the place of business.
4. The complete devices are subject to warranty, and the sort of defect shall be described in written in a correctly fulfilled claim notification.
5. If a claim is accepted, the manufacturer is obliged to perform warranty repairs as soon as possible, but no later than 14 working days since the device is provided to the service of the manufacturer.
6. The repair period specified in item 5 can be extended, if there are no technical opportunities to perform the repair or the equipment is conditionally accepted by the service due to non-compliance of the warranty conditions by the person lodging a claim.
7. All service actions related to warranty are performed exclusively at the service of the manufacturer.
8. The warranty does not include the following defects of the device due to:
 - manufacturer-independent reasons,
 - mechanical defects,
 - improper storage and transport,
 - operation contrary to the instruction manual or purpose of the device,
 - emergencies, including atmospheric discharges, failures of the power network, fire, flood, effect of high temperature and chemical agents,
 - improper installation and configuration (contrary to the instruction manual)
9. The loss of rights resulting from the warranty always occurs, if it is confirmed that construction changes have been performed or repairs have not been performed at the service of the manufacturer, or if serial numbers or warranty labels of the device are somehow replaced or damaged.
10. The responsibility of the manufacturer towards the purchaser is limited to the value of the device determined according to the wholesale price from the purchase day suggested by the manufacturer.
11. The manufacturer does not bear any responsibility for damages resulting from failure, faulty operation or inability to use the device, particularly if it results from non-compliance with advices and requirements included in the instruction manual or contrary to purpose of the device.

Pulsar K.Bogusz Sp.j.

Siedlec 150, 32-744 Łapczyca, Poland
Tel. (+48) 14-610-19-40, Fax. (+48) 14-610-19-50
e-mail: biuro@pulsar.pl, sales@pulsar.pl
[http:// www.pulsar.pl](http://www.pulsar.pl)